

**FM 96 WINDOW  
HARDWARE & STRAP DETAIL  
( SERIAL#15001 TO 19670 )**

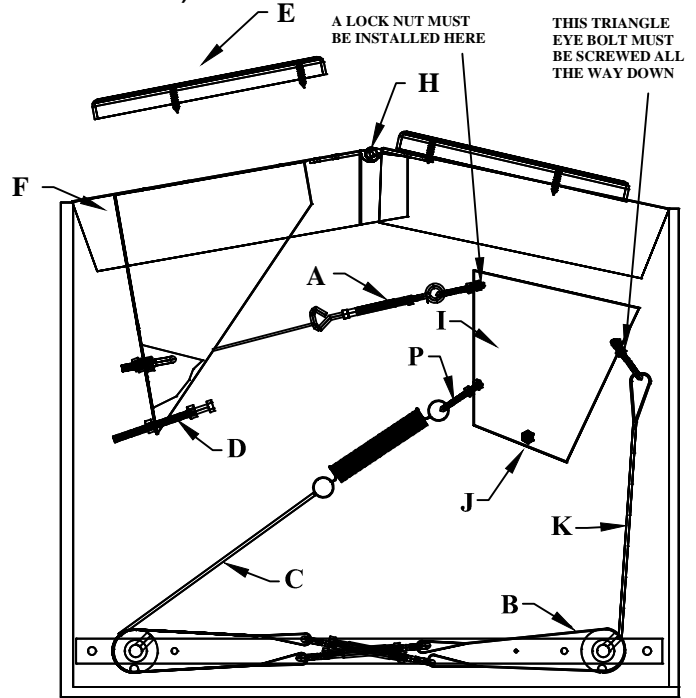

" BOTTOM VIEW "

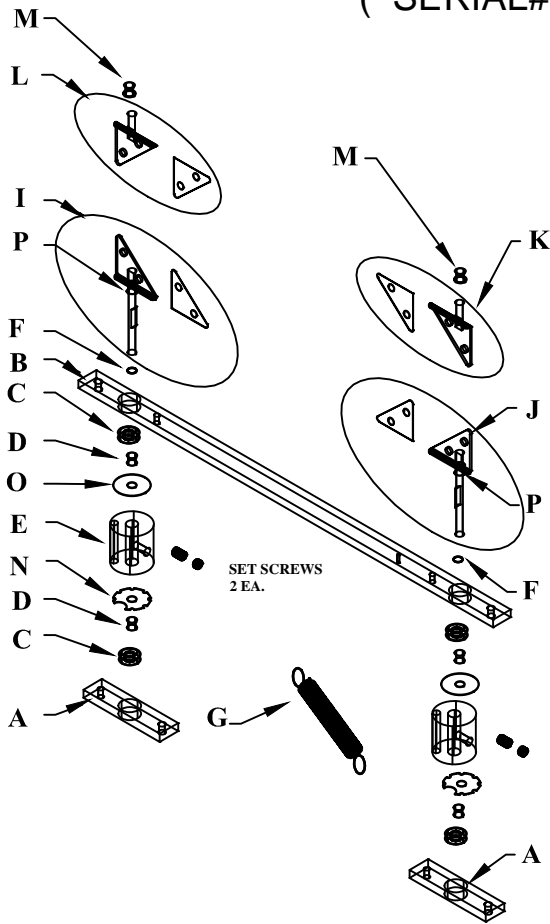
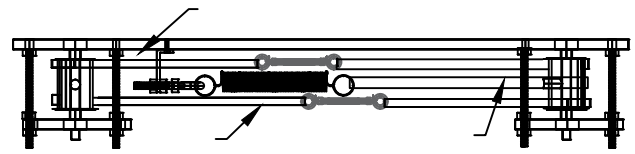

" EXTERIOR VIEW "

KEY NO	PART NO	DESCRIPTION
A	5582	BOTTOM BEARING BAR
B	5583	UPPER BEARING BAR
C	1012	BEARING
D	1004	ROLLER SPACER BUSHING
E	5587	ALUMINUM ROLLER \ SET SCREWS
F	1013	RUBBER O-RING
G	1005	RETURN SPRING
I	5590	L/H BOTTOM HINGE
J	5591	R/H BOTTOM HINGE
K	5593	R/H TOP HINGE
L	5592	L/H TOP HINGE
M	1006	TOP HINGE BUSHING
N	3631	BOTTOM RETAINER WASHER
O	3643	TOP RETAINER WASHER
P	1915	HINGE SPACER BUSHING

KEY NO	PART NO	DESCRIPTION
A	5564	PULL STRAP TO BAR ASSEMBLY
B	5560	ROLLER STRAP ASSEMBLY QTY (2)
C	5565	RETURN SPRING STRAP ASSEMBLY
D	5201	TRAVEL ADJUSTER
E	2103	PUSH PAD QTY (2)
F	5557	PUSH BAR ASSEMBLY
G	5599	COMPLETE SET OF STRAPS
H	1914	HINGE PIN
I	5600	LEVERAGE BRACKET
J	5217	LEVERAGE BRACKET BOLT
K	5563	ROLLER PULL STRAP ASSEMBLY
P	5214	EYE BOLT

NOTE: THIS DRAWING EMBODIES A CONFIDENTIAL PROPRIETARY DESIGN ORIGINATED AND OWED BY QUIKSERV CORP., AND IS SUBMITTED UNDER A CONFIDENTIAL RELATIONSHIP. ALL PATENT, MANUFACTURING, SALE RIGHTS REGARDING THE SAME ARE RESERVED EXCEPT TO THE EXTENT RIGHTS ARE EXPRESSLY GRANTED TO OTHERS. THE RECIPIENT AGREES BY ACCEPTING THESE DRAWINGS NOT TO SUPPLY OR DISCLOSE ANY INFORMATION REGARDING THEM TO ANY UNAUTHORIZED PERSON.

**Quikserv Corp.**  
www.quikserv.com  
1-800-388-8307

**FM HARDWARE & STRAP DETAIL 15000 TO 19689**

Submitted By:  
Brian Coble

DATE:  
5/14/2015

Sheet:  
FM96-SD